

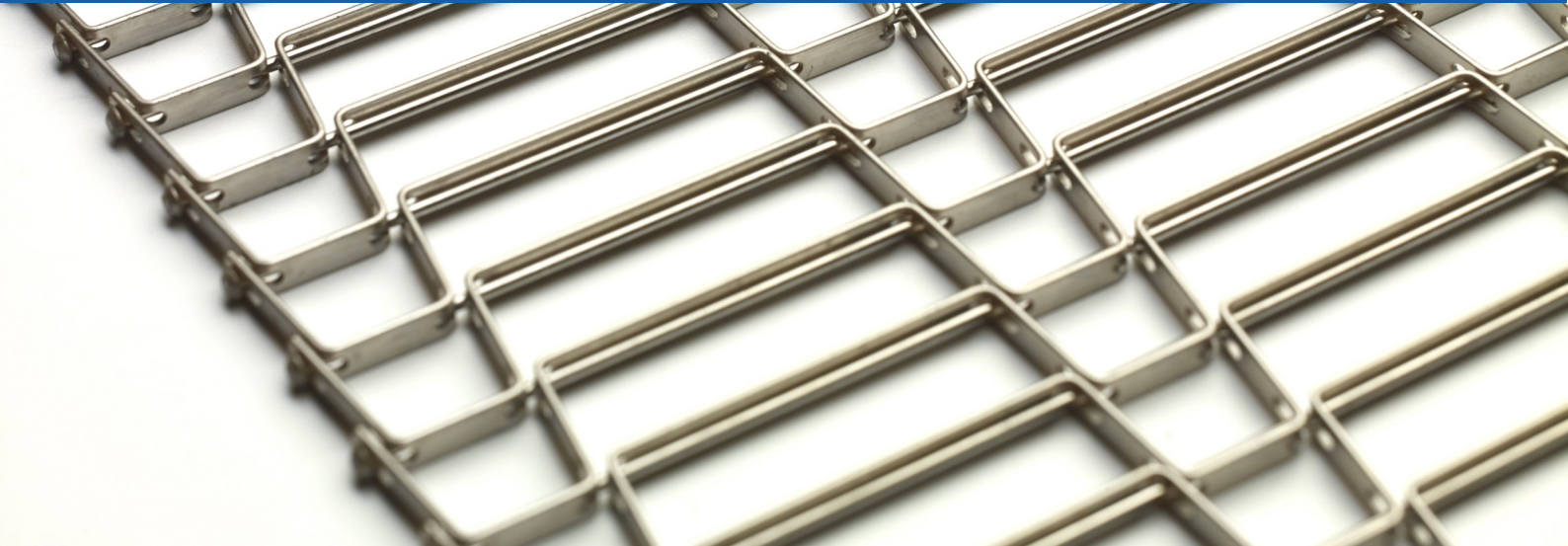

The Trusted Metal Conveyor Belt Manufacturer



Versa-Link[®] Conveyor Belt

————— Metal Conveyor Belt, Simplified! —————

Advantages

- **Advanced Link Rods™** - Links in as little as 30 seconds!
- **Forged Edge Technology™** - No catch points! No hook or sharp edges!
- No special tools or welding required
- Twice the life of competitive belts*
- Positively driven for excellent belt tracking
- Up to 81% open area for excellent flow through
- Allows for tight transfers
- USDA accepted
- Available in 9.53mm and 12mm pitch
- Available up to 3810mm wide

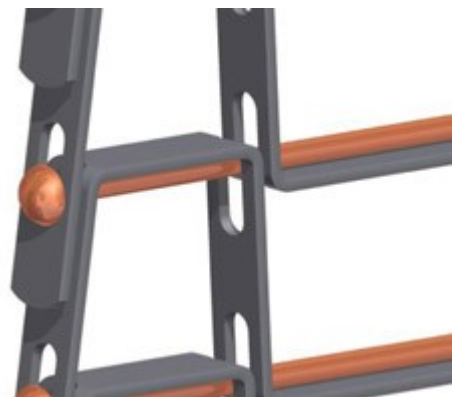

* based on testing under controlled conditions

Wire Belt Company Ltd, Castle Road
Eurolink Industrial Centre, Sittingbourne, Kent ME10 3RF
Tel: +44 (0) 1795 421771 | Fax: +44 (0) 1795 428905 | Email: sales@wirebelt.co.uk

www.wirebelt.co.uk

Versa-Link® Conveyor Belt

Available Specifications

Belt Pitch:	12.70
	9.53
Belt Spacing:	Varies upon application
Belt Thickness:	4.06
Belt Width Range:	up to 3810
Belt Materials:	Wear Resistant Stainless Steel
Sprocket Materials:	Stainless Steel, POM and PEEK available

Drive Components

Sprocket Chart									
9.53mm Pitch					12.7mm Pitch				
Pitch	Number of Teeth	O.D.	Root	Max Bore (with key-way)	Pitch	Number of Teeth	O.D.	Root	Max Bore (with key-way)
9.53	11	37.87	29.74	16	12.7	8	37.25	29.12	16
9.53	13	43.86	35.74	22	12.7	10	45.16	37.03	22
9.53	16	52.89	44.76	30	12.7	12	53.13	45.01	30
9.53	20	64.95	56.82	40	12.7	15	65.15	57.02	40
9.53	24	77.04	68.91	48	12.7	18	77.20	69.07	48
9.53	32	101.24	93.11	72	12.7	24	101.36	93.23	72

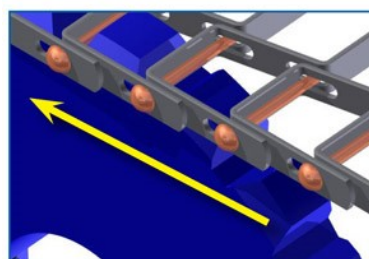
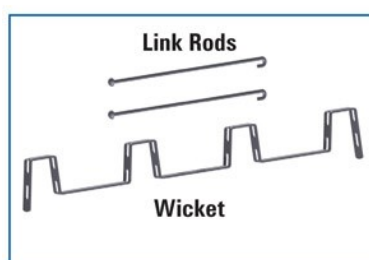

Direction of travel

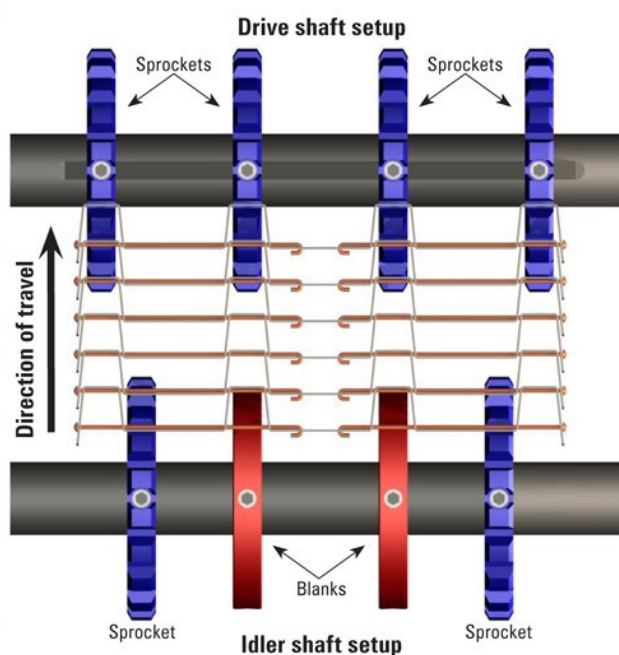

Wire Belt Company Ltd, Castle Road

Eurolink Industrial Centre, Sittingbourne, Kent ME10 3RF

Tel: +44 (0) 1795 421771 | Fax: +44 (0) 1795 428905 | Email: sales@wirebelt.co.uk

www.wirebelt.co.uk